



Sidney Avenue, Palmers Green, London, N13  
Chain Free £295,000 Leasehold - Share of Freehold

**Anthony Webb**  
ESTATE AGENTS

# Sidney Avenue, Palmers Green, London, N13

Well presented one double bedroom Victorian first floor flat located in the heart of Palmers Green. Would be ideal for a first time buyer or buy to let investor (could achieve £1450-£1500pcm)

Sidney Avenue is ideally located off Green Lanes, close to shops, restaurants, bus routes and stations including Palmers Green, Bowes Park and Wood Green underground.

The property has been beautifully modernised and benefits from a modern fitted kitchen/diner with contemporary glass wall and door to living room, modern shower room, double bedroom with fitted wardrobes, gas central heating, double glazing, laminate floors and secure communal entrance.

The property is offered with a new lease of 999 years

Ground rent-£0

Service charges-£0

Council Tax band C

- One double bedroom
- Beautifully modernised
- First floor converted flat
- Modern kitchen/diner
- Modern shower room
- Close to shops & stations





Sidney Avenue  
 Palmers Green  
 London  
 N13 4UY

Tenure: Leasehold - Share of Freehold  
 Gross Internal Area: 420.00 sq ft

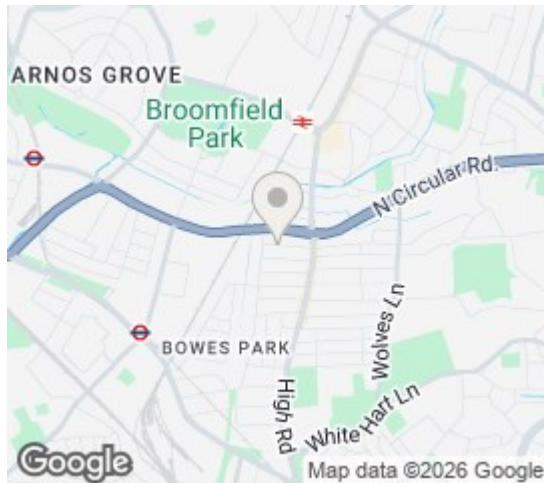

Energy Efficiency Rating		Current	Potential
Very energy efficient - lower running costs			
(92 plus) A			
(81-91) B			
(69-80) C		78	80
(55-68) D			
(39-54) E			
(21-38) F			
(1-20) G			
Not energy efficient - higher running costs			
England & Wales		EU Directive 2002/91/EC	
Environmental Impact (CO <sub>2</sub> ) Rating		Current	Potential
Very environmentally friendly - lower CO <sub>2</sub> emissions			
(82 plus) A			
(61-81) B			
(39-80) C			
(15-48) D			
(39-54) E			
(21-38) F			
(1-20) G			
Not environmentally friendly - higher CO <sub>2</sub> emissions			
England & Wales		EU Directive 2002/91/EC	

Sidney Road, N13  
 Approximate Gross Internal Area = 39.1 sq m / 420 sq ft

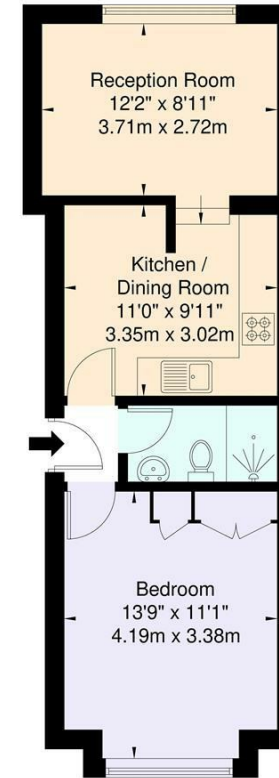

First Floor

For Illustration Purposes Only - Not To Scale

This floor plan should be used as a general outline for guidance only and does not constitute in whole or in part an offer or contract. Any intending purchaser or lessee should satisfy themselves by inspection, enquiries and full survey as to the correctness of each statement. Any areas, measurements or distances quoted are approximate and should not be used to value a property or be the basis of any sale or let.

Property particulars as supplied by Anthony Webb Estate Agents are set out as a general outline in accordance with the Property Misdescriptions Act (1991) only for the guidance of intending purchasers of lessees, and do not constitute any part of an offer or contract. Details are given without any responsibility, and any intending purchasers, lessees or third parties should not rely on them as inspection or otherwise as to the correctness of each of them. We have not carried out a structural survey and the services, appliances and specific fittings have not been tested. All photographs, measurements, floor plans and distances referred to are given as a guide only and should not be relied upon for the purchase of carpets or any other fixtures statements or representations of fact, but must satisfy themselves by or of fittings, gardens, roof terraces, balconies and communal gardens as well as tenure and lease details cannot have their accuracy guaranteed for intending purchasers. Lease details, service ground rent (where applicable) are given as a guide only and should be checked and confirmed by your solicitor prior to exchange of contracts. no person in the employment of Anthony Webb has any authority to make any representation or warranty whatever in relation to this property.

348 Green Lanes, Palmers Green, London N13 5TJ  
 020 8882 7888  
 palmersgreen@anthonywebb.co.uk  
 anthonywebb.co.uk

